

Attachment holder, Type A

For swing type

Accessories

AHDA5 : EX series/EXZ series/EXZII series

Attachment holder
A5

| | |
|--------------|----------------------|
| Product name | Attachment holder A5 |
| Part code | AHDA5 |
| Weight | 239g |
| Material | A5052P |

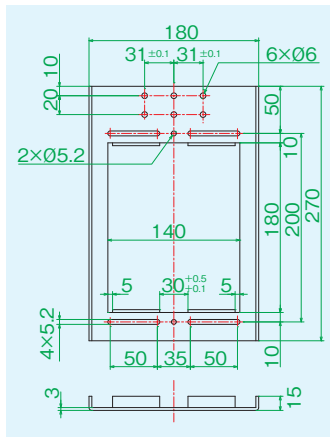

Usage example: Vacuum type, for swing-type robot

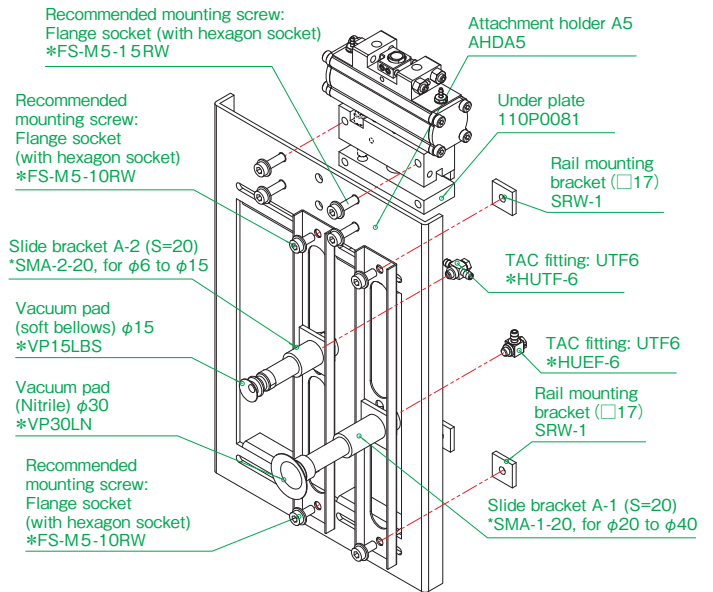

Attachment holder, Type A

Traverse type, Common

Accessories

AHDA6 · AHDA7 : HRX series : HSX series : HLIII series

Attachment holder
A6

Attachment holder
A7

| Product name | Attachment holder A6 | Attachment holder A7 |
|--------------|----------------------|----------------------|
| Part code | AHDA6 | AHDA7 |
| Weight | 300g | 329g |
| Material | A5052P | A5052P |



*With round hole.
See the drawing.

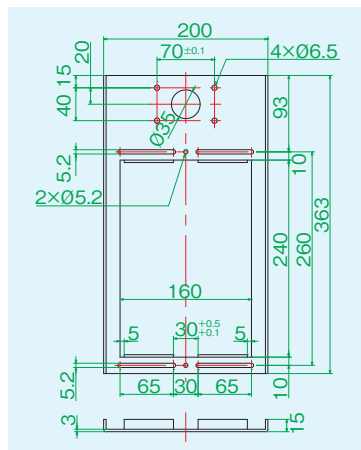
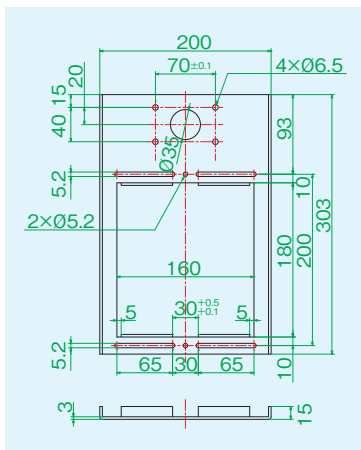

(Usage example)
For traverse type

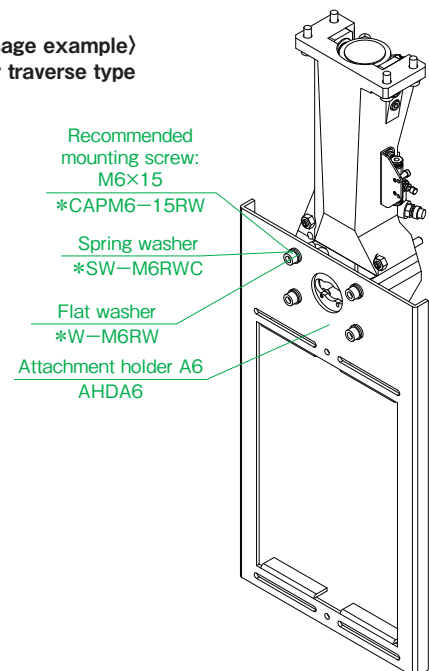

Attachment holder, Type B

All traverse types

Accessories

AHDB2 : HRX SERIES : HSX SERIES

Attachment holder B2

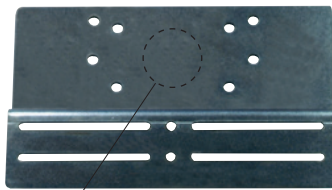

*With round hole. See the drawing.

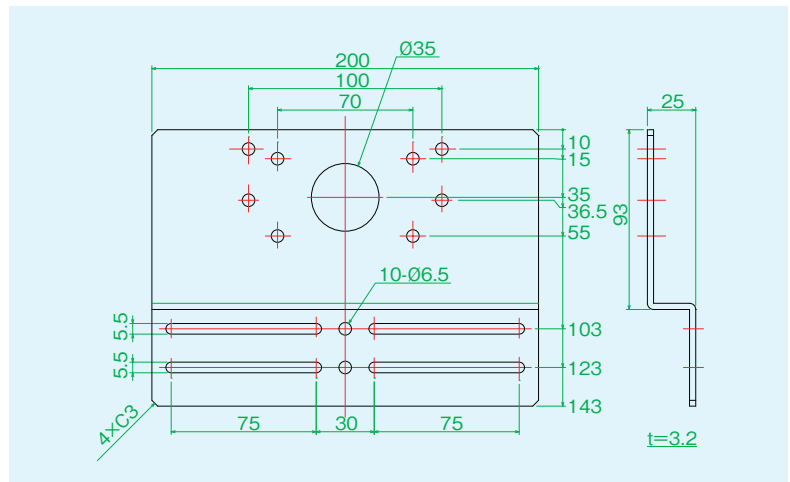

| | |
|--------------|----------------------|
| Product name | Attachment holder B2 |
| Part code | AHDB2 |
| Weight | 674g |
| Material | SPCC |

Attachment holder, Type B

For swing type

Accessories

AHDB1 : EX SERIES

Attachment holder B1

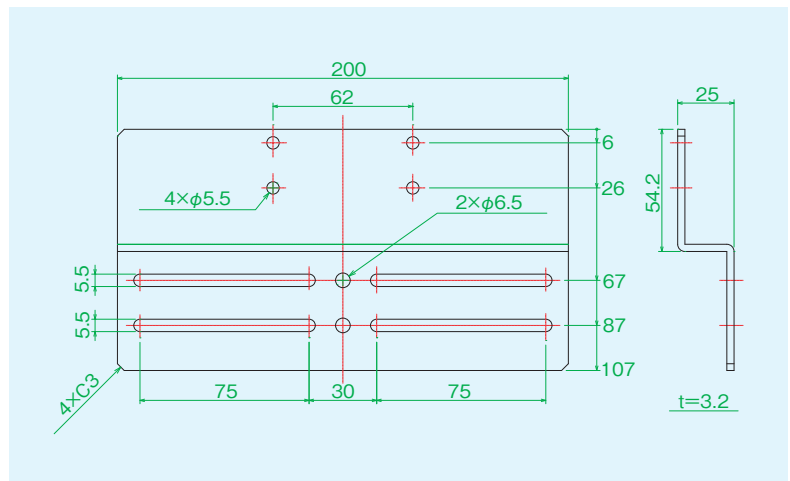
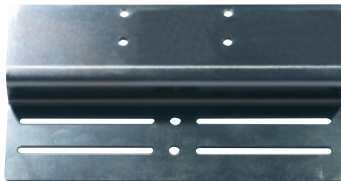

| | |
|--------------|----------------------|
| Product name | Attachment holder B1 |
| Part code | AHDB1 |
| Weight | 675.2g |
| Material | SPCC |

Usage example: Vacuum type, for swing-type robot

Slide rail SLDRD1 / SLDRD2 / SLDRD3 / SLDRD4 / SLDRD5

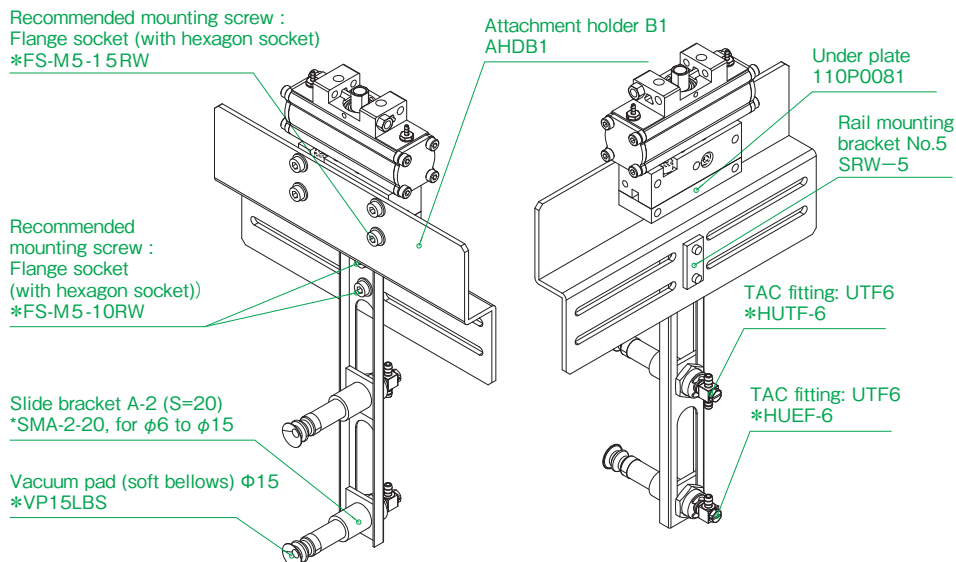

Attachment holder, Type C

Traverse type, Common

Accessories

AHDC1 : HRX SERIES : HSX SERIES

Attachment holder C1

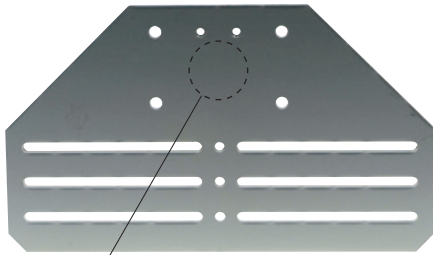

*With round hole. See the drawing.

| | |
|--------------|----------------------|
| Product name | Attachment holder C1 |
| Part code | AHDC1 |
| Weight | 330g |
| Material | A5052P |

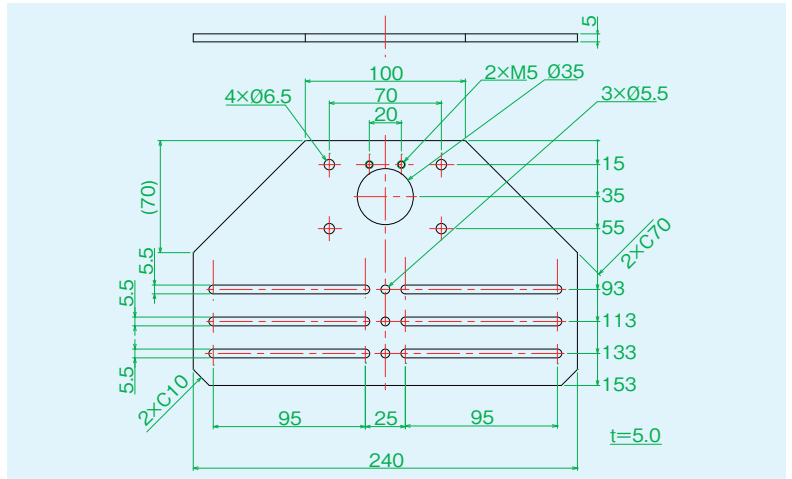

Attachment holder, Type C

For swing type

Accessories

AHDC2 : EX SERIES

Attachment holder C2

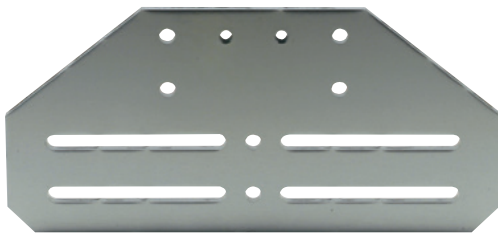

| | |
|--------------|----------------------|
| Product name | Attachment holder C2 |
| Part code | AHDC2 |
| Weight | 153g |
| Material | A5052P |

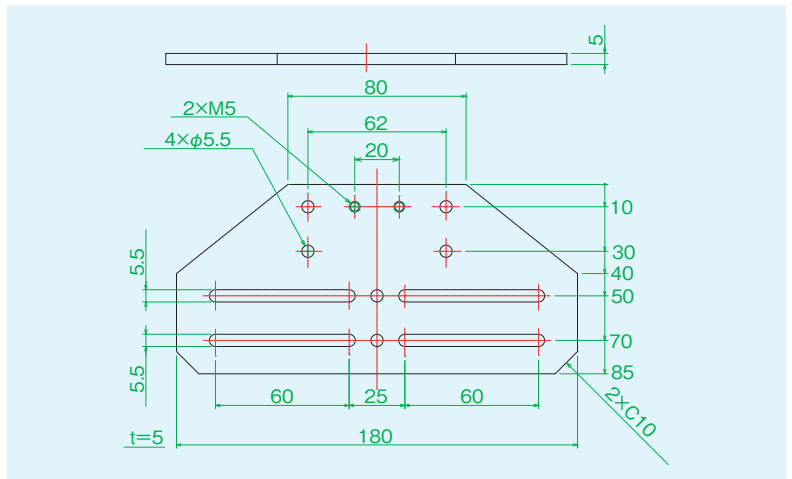

Attachment holder, Type C

Traverse type, Common

Accessories

AHDC3 : HRX SERIES : HSX SERIES : EX SERIES

Attachment holder C3

(Usage example)

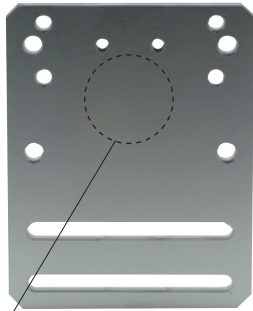

*With round hole. See the drawing.

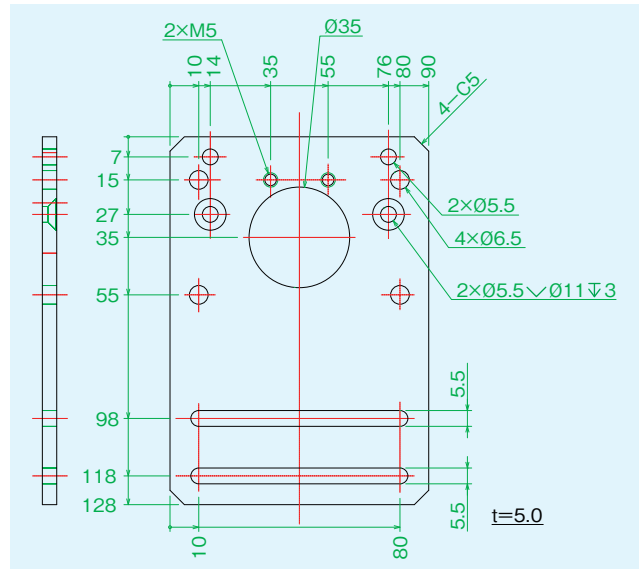
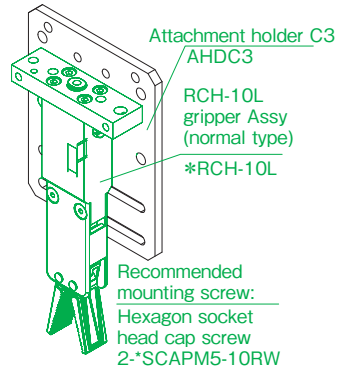

| | |
|--------------|----------------------|
| Product name | Attachment holder C3 |
| Part code | AHDC3 |
| Weight | 120g |
| Material | A5052P |

Usage example of AHDC3: Gripper type: for traverse type robot RCH10/RCH18

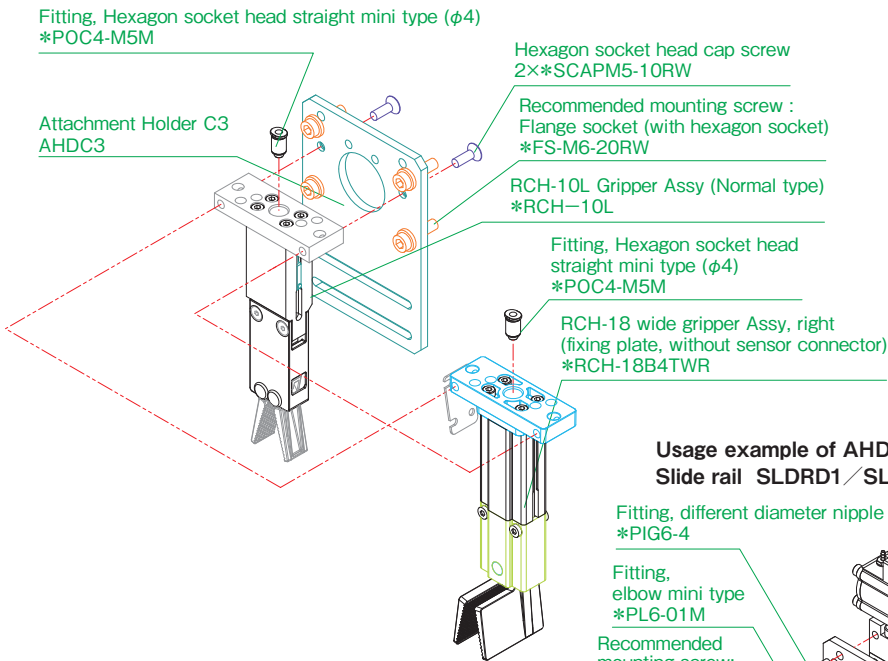

Usage example of AHDC3: Vacuum type, for swing-type robot Slide rail SLDRD1/SLDRD2/SLDRD3/SLDRD4/SLDRD5

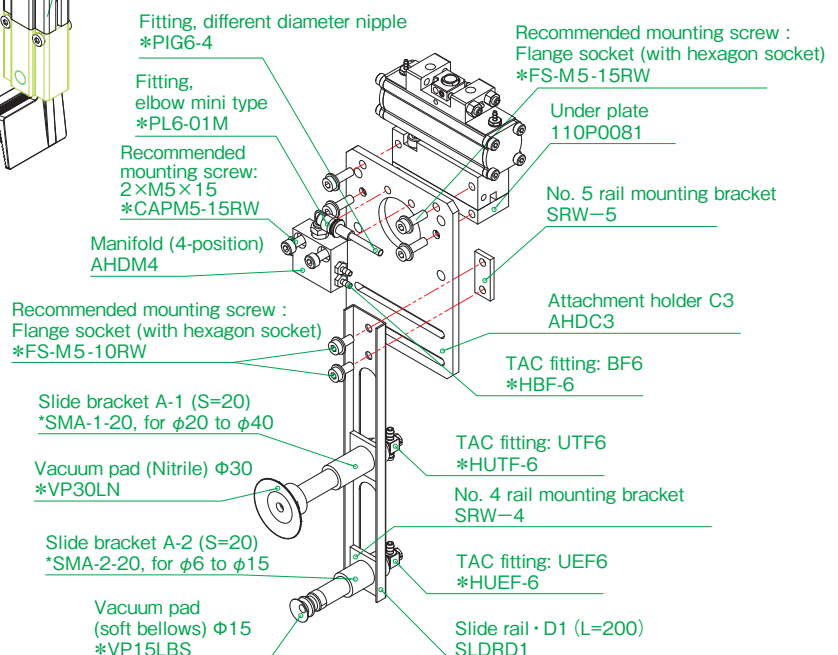

Attachment holder, Type D Traverse type, Common

Accessories

AHDD1 : HRXII-i/b/a : HLIII : HSX SERIES : HRX SERIES

Attachment holder D1

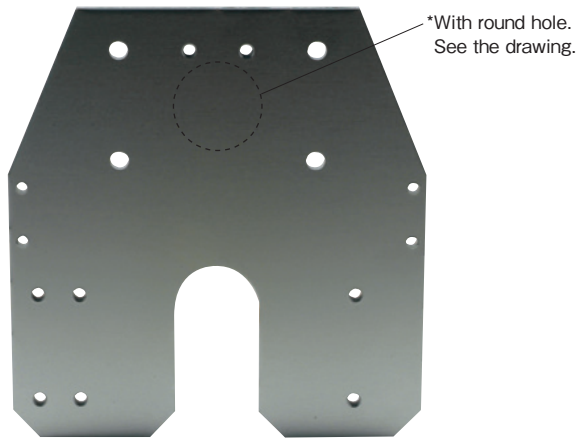

| | |
|--------------|----------------------|
| Product name | Attachment holder D1 |
| Part code | AHDD1 |
| Weight | 265g |
| Material | A5052P |

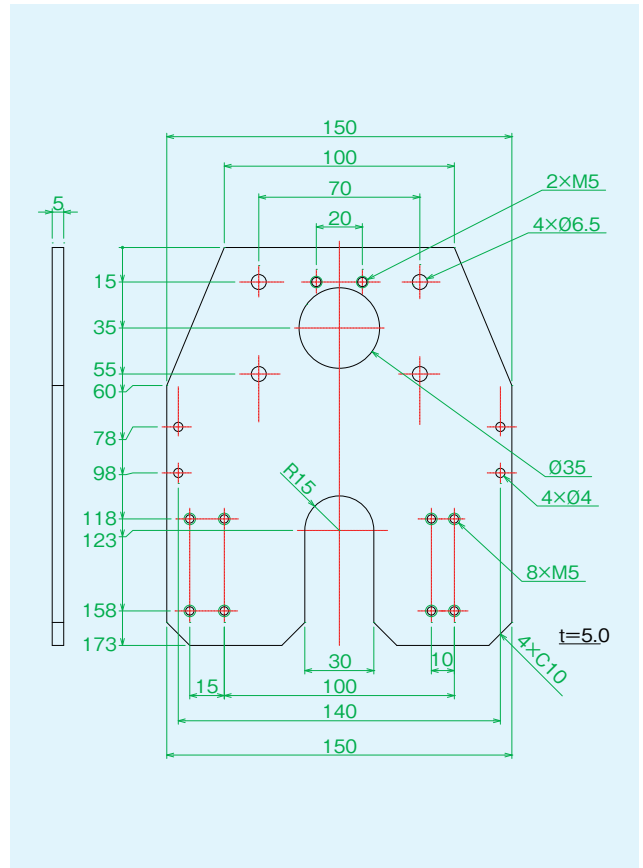
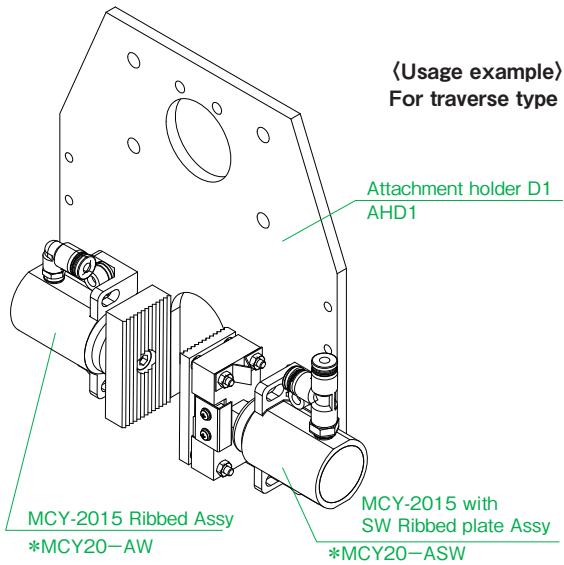

Usage example of AHDD1: Gripper type, for traverse-type robot

